

CONTACT CALL BEFORE YOU DIG (CBYD) BEFORE ANY EXCAVATION
 PHONE (800) 922-4455

NOTES:
 Underground facilities, structures, and utilities have been plotted from available surveys and records, and therefore their locations must be considered approximate only. There may be others, the existence of which is presently not known. Anyone using utility information and data provided herein shall "Call before you dig" at 1-800-922-4455 forty eight (48) hours in advance to verify the location of utilities prior to start of construction.

MAP NOTES:

- This plan was compiled from other maps, record research or other sources of information. It is not to be construed as having been obtained as the result of a field survey, and is subject to such change as an accurate field survey may disclose.
- Layout mapping was provided by Meehan & Goodin, Inc. Please note mapping denotes layout as is was proposed by Meehan & Goodin, Inc. and it should not be construed as an as-built plan.
- Dimensions for curb replacement shown on this plan are approximate. The contractor shall check these in the field.



PREPARED BY:
 TOWN OF EAST HARTFORD
 DEPARTMENT OF PUBLIC WORKS
 ENGINEERING DIVISION

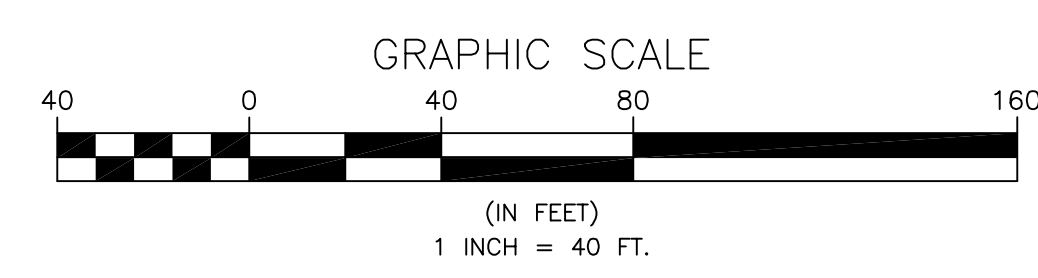

- LEGEND**
- SEDIMENTATION CONTROL SYSTEM AT CATCH BASIN
 - CONCRETE CURB (WITHOUT SIDEWALK) (DETAIL "A")
 - MONOLITHIC CONCRETE SIDEWALK AND CURB (DETAIL "B")
 - PAVEMENT SAWCUT

EAST HARTFORD PUBLIC SAFETY COMPLEX
SITE PLAN
CONCRETE CURB REPLACEMENT

DATE 1/30/17 DRAWN BY ARA APPROVED BY MDH SHEET 1/2

GENERAL CONSTRUCTION NOTES:

1. THE PROJECT CONSISTS OF REMOVAL AND REPLACEMENT OF APPROXIMATELY 700' OF DAMAGED CONCRETE CURB AND 2500 S.F. OF SIDEWALK AT THE EAST HARTFORD PUBLIC SAFETY COMPLEX. THE REPLACEMENT CURB AND SIDEWALK SHALL BE MONOLITHIC CAST-IN-PLACE CONCRETE.
2. THE HANDICAPPED RAMP INDICATED ON THE PLANS IS TO BE REPLACED IN ACCORDANCE WITH THE FEDERAL AMERICANS WITH DISABILITIES ACT AND WITH STATE AND LOCAL LAWS AND REGULATIONS (WHICHEVER ARE MORE STRINGENT).
3. ACCESS TO THE PUBLIC SAFETY COMPLEX SHALL BE PROVIDED AT ALL TIMES DURING CONSTRUCTION.
4. AREAS OUTSIDE THE PROJECT LIMITS TO BE DISTURBED BY THE CONSTRUCTION ACTIVITIES WILL BE RESTORED WITHOUT ADDITIONAL COST TO THE TOWN.
5. THE CONTRACTOR WILL BE RESPONSIBLE FOR PROVIDING WATER FOR DUST CONTROL.
6. ALL CURB LENGTHS AND RADII INDICATED ON THE PLANS ARE MEASURED AT THE FACE OF CURB.
7. THE CONTRACTOR SHALL BE AWARE THAT THERE ARE A NUMBER OF UTILITIES PRESENT IN THE WORK AREAS. THE CONTRACTOR SHALL CONTACT "CALL-BEFORE-YOU-DIG" AT 1-800-922-4455 BEFORE COMMENCING THE WORK. CONTRACTOR IS RESPONSIBLE FOR PROTECTING UTILITIES OR REPLACING OR REPAIRING THEM TO THE SATISFACTION OF THE ENGINEER AT ITS OWN EXPENSE.
8. TRACKED VEHICLES AND OTHER EQUIPMENT ARE NOT ALLOWED ON BITUMINOUS CONCRETE OR OTHER PAVED AREAS.

GENERAL NOTES:

1. MAXIMUM SLOPES OF ADJOINING GUTTERS AND ROAD SURFACES IMMEDIATELY ADJACENT TO THE SIDEWALK RAMP SHOULD NOT EXCEED 5%. THE MAXIMUM GRADE DIFFERENCE BETWEEN THE GUTTER AND CURB RAMP SHALL NOT EXCEED 13%.
2. RAMP GRADE SHALL BE UNIFORM, FREE OF SAGS AND ABRUPT GRADE CHANGES. RUNNING SLOPES OF RAMPS SHALL NOT EXCEED 8.33%.
3. ALL RAMPS SHALL BE CONSTRUCTED OF EAST HARTFORD SIDEWALK MIX DESIGN CONCRETE (SEE SECTION "9b-SPECIAL PROVISIONS" OF THE BID DOCUMENTS).
4. SIDEWALK RAMPS SHALL HAVE A COARSE BROOM FINISH TRANSVERSE TO THE SLOPE OF THE RAMP. THE SURFACE OF ALL SIDEWALK RAMPS SHALL BE STABLE, FIRM AND SLIP RESISTANT. SURFACE DISCONTINUITIES SHALL NOT EXCEED 1/4" MAX. VERTICAL DISCONTINUITIES BETWEEN 1/4" AND 1/2" MAX. SHALL BE BEVELED 1:2 MINIMUM APPLIED ACROSS THE ENTIRE LEVEL CHANGE.
5. REMOVAL OF EXISTING SIDEWALK FOR NEW RAMP INSTALLATION SHALL BE TO THE NEAREST EXPANSION OR CONTRACTION JOINT. 8.33% MAXIMUM SLOPE MAY NOT BE ACHIEVABLE DUE TO EXISTING SIDEWALK GRADE. IN RECOGNITION OF THIS, A LIMIT OF 15' FOR REMOVAL SHALL BE USED UNLESS OTHERWISE SHOWN ON THE PLANS OR DIRECTED BY THE ENGINEER.
6. EXPANSION JOINTS IN CONCRETE SHALL MATCH THOSE IN ADJACENT SIDEWALKS BUT IN NO CASE SHALL THE SPACING BETWEEN EXPANSION JOINTS EXCEED 12' UNLESS OTHERWISE NOTED.
7. CURBING AT SIDEWALK RAMPS SHALL ABIDE BY THE FOLLOWING:
 - A. TRANSITION TO FULL HEIGHT AND FLUSH CURBING AT THE BASE OF THE RAMP SHALL BE CONCRETE CURBING.
 - B. CONCRETE CURBING SHALL AT THE LOCATIONS AND TO THE EXTENTS SHOWN ON THE PLANS, OR AS ORDERED BY THE ENGINEER. CONCRETE CURBING ALONG A CURVE SHALL BE CURVED CONCRETE CURBING TO MATCH THE EXISTING CURB RADII OR THE PROPOSED RADII SPECIFIED IN THE PLANS.
 - C. SEE CONCRETE CURB DETAIL FOR ADDITIONAL CONSTRUCTION REQUIREMENTS.
8. PREFERRED LOCATION TO INSTALL DETECTABLE WARNING STRIP SHALL BE 6" FROM THE EDGE OF ROAD ALONG THE FULL WIDTH OF THE RAMP.
9. TO PERMIT WHEELCHAIR WHEELS TO ROLL BETWEEN DOMES, ALIGN DOMES IN A SQUARE GRID IN THE DIRECTION OF RUNNING SLOPE (PERPENDICULAR TO CURB OR SLOPE BREAK). THE TRANSITION FROM RAMP TO GUTTER SHALL BE FLUSH WITHOUT A LIP.
10. THE TOP AND BOTTOM OF RAMPS SHOULD BE PROVIDED WITH A 4'x4' MINIMUM LEVEL LANDING AREA WITH A CROSS SLOPE LESS THAN OR EQUAL TO 2% IN ANY DIRECTION.
11. APPROACH SIDEWALK AND LANDING CROSS SLOPE SHALL NOT EXCEED 2%.
12. FOR PERPENDICULAR CURB RAMPS A MIN. 4'x4' LEVEL LANDING SHALL BE PROVIDED AT THE TOP OF CURB RAMP. WHERE THE LEVEL LANDING IS RESTRICTED AT THE BACK OF THE SIDEWALK THE LEVEL LANDING SHALL BE 4'x5' WITH THE LARGER DIMENSION PROVIDED IN THE DIRECTION OF THE RAMP RUN.
13. FOR PARALLEL CURB RAMPS A MIN. 4'x4' LEVEL LANDING SHALL BE PROVIDED AT THE TOP OF CURB RAMP. WHERE THE LEVEL LANDING IS RESTRICTED ON TWO OR MORE SIDES, THE LEVEL LANDING SHALL BE 4'x5' WITH THE LARGER DIMENSION PROVIDED IN THE DIRECTION OF THE PEDESTRIAN STREET CROSSING.
14. WHEN WIDTH OF SIDEWALK IS EQUAL OR LARGER THAN 48" AND A PERPENDICULAR SIDEWALK RAMP IS INSTALLED, THE FLARED SIDES SHALL BE 10% MAX. IF THE WIDTH IS SMALLER THAN 48", THE FLARED SIDES MUST NOT EXCEED 8.33% (12:1).
15. SHADED AREAS ARE TYPICAL PAY LIMITS FOR CONCRETE SIDEWALK RAMP BUT MAY VARY AS DIRECTED BY THE ENGINEER.
16. THE APPROACH SLAB SHALL TRANSITION FROM THE TOWN'S STANDARD 2% TO 1.5% ADJACENT TO THE RAMP.

DRAINAGE NOTES:

1. THE PROPOSED CATCH BASIN TOP REPLACEMENT SHALL BE TYPE "C" FOR CONCRETE CURBING.
2. THE CONTRACTOR SHALL INSTALL THE NEW CATCH BASIN TOP TO PROVIDE POSITIVE DRAINAGE INTO THE STRUCTURE.

EROSION AND SEDIMENTATION CONTROL NOTES:

1. THE CONTRACTOR SHALL CONTROL STORMWATER RUNOFF DURING CONSTRUCTION TO PREVENT ADVERSE IMPACTS TO AREAS OUTSIDE CONSTRUCTION LIMITS.
2. THE CONTRACTOR SHALL INSTALL "SILT SACK" AS SHOWN ON THE PLANS PRIOR TO THE BEGINNING OF CONSTRUCTION AT THE LOCATION SHOWN ON THE PLANS.
3. THE CONTRACTOR SHALL INSPECT AND MAINTAIN EROSION CONTROL MEASURES AND REMOVE SEDIMENT THEREFROM ON A WEEKLY BASIS AND WITHIN TWELVE HOURS AFTER EACH STORM EVENT AND REMOVE SEDIMENTS IN ACCORDANCE WITH THE SPECIFICATIONS.
4. THE CONTRACTOR SHALL BE FULLY RESPONSIBLE FOR CONTROLLING CONSTRUCTION ACTIVITIES SUCH THAT THEY WILL NOT ADVERSELY IMPACT REGULATED AREAS.
5. UPON COMPLETION OF CONSTRUCTION AND ESTABLISHMENT OF PERMANENT GROUND COVER, THE CONTRACTOR SHALL REMOVE AND DISPOSE OF EROSION CONTROL MEASURES.

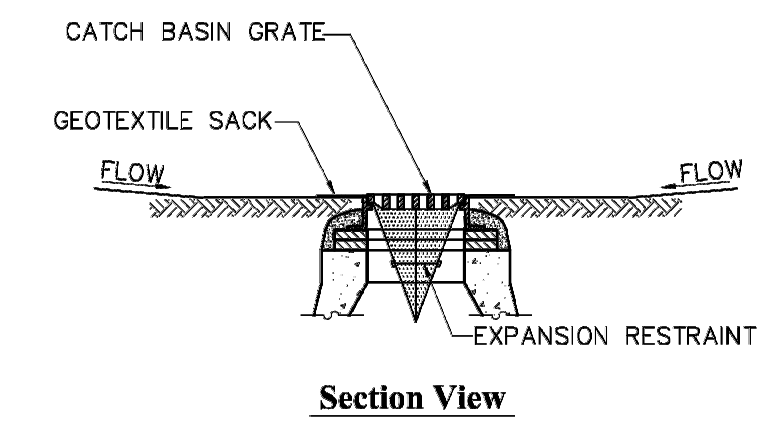
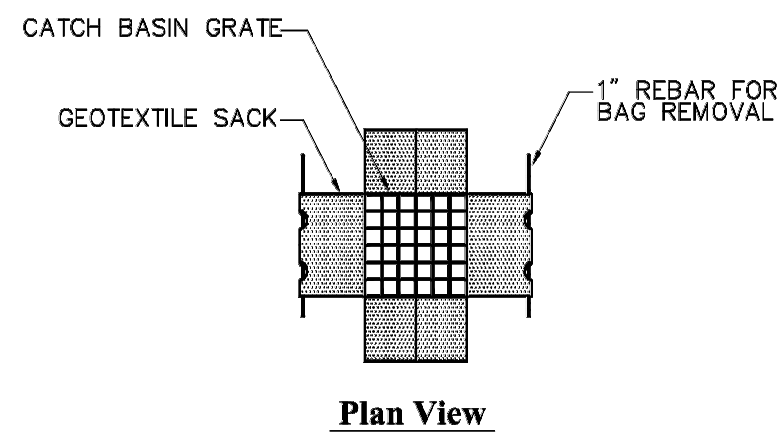

DETAIL NOTES:

1. INSTALL GEOTEXTILE SACK IN ALL CATCH BASINS WHERE INDICATED ON THE PLAN OR AS DIRECTED BY THE ENGINEER BEFORE COMMENCING WORK.
2. GRATE TO BE PLACED OVER GEOTEXTILE SACK.
3. GEOTEXTILE SACK SHALL BE INSPECTED PERIODICALLY AND AFTER ALL STORM EVENTS AND CLEANING OR REPLACEMENT SHALL BE PERFORMED PROMPTLY AS NEEDED. MAINTAIN UNTIL UPSTREAM AREAS HAVE BEEN PERMANENTLY STABILIZED.

SEDIMENTATION CONTROL SYSTEM AT CATCH BASIN
N.T.S.

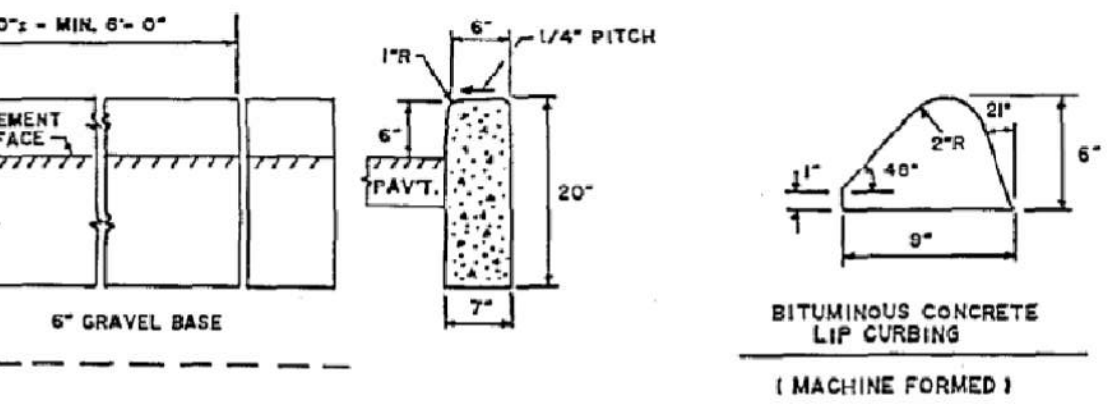
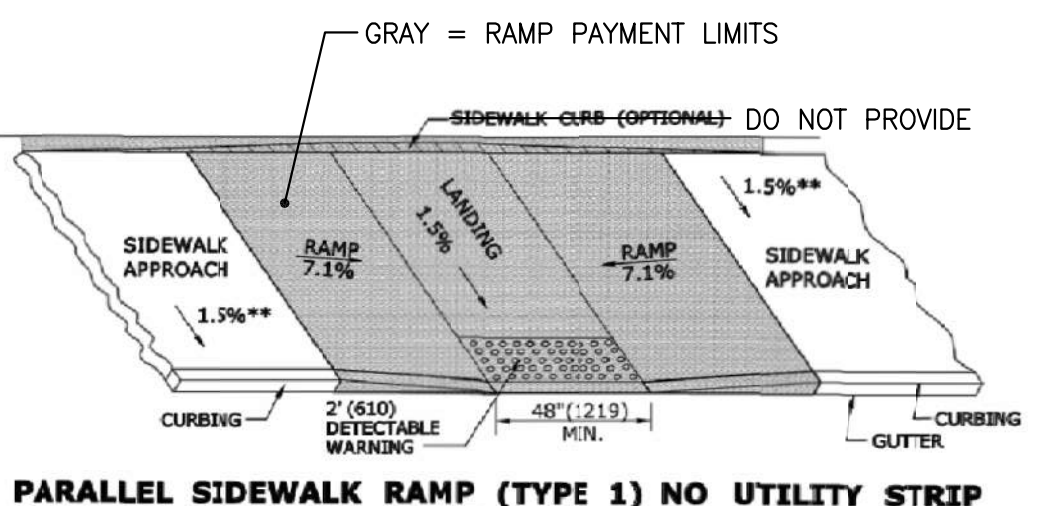

TOWN OF EAST HARTFORD STANDARD DETAIL

CURBING

NO.	DESCRIPTION	DATE	APPROVE

DATE: JUNE 1993

B-6

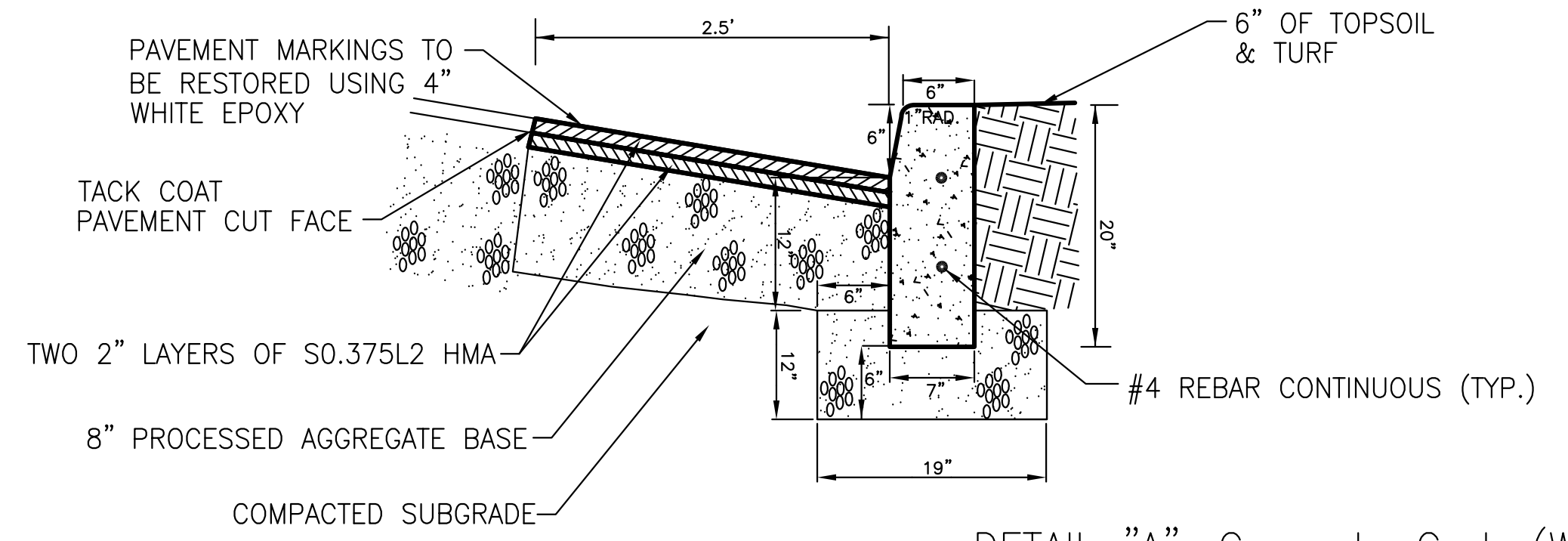

DETAIL "A": Concrete Curb (Without Sidewalk)

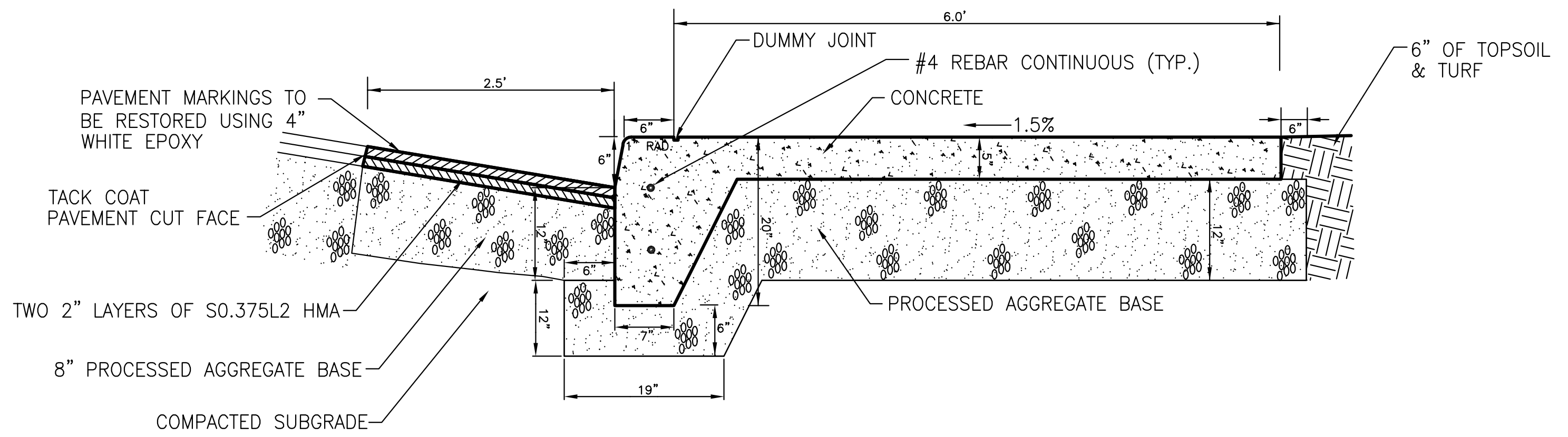

DETAIL "B": Monolithic Concrete Sidewalk and Curb

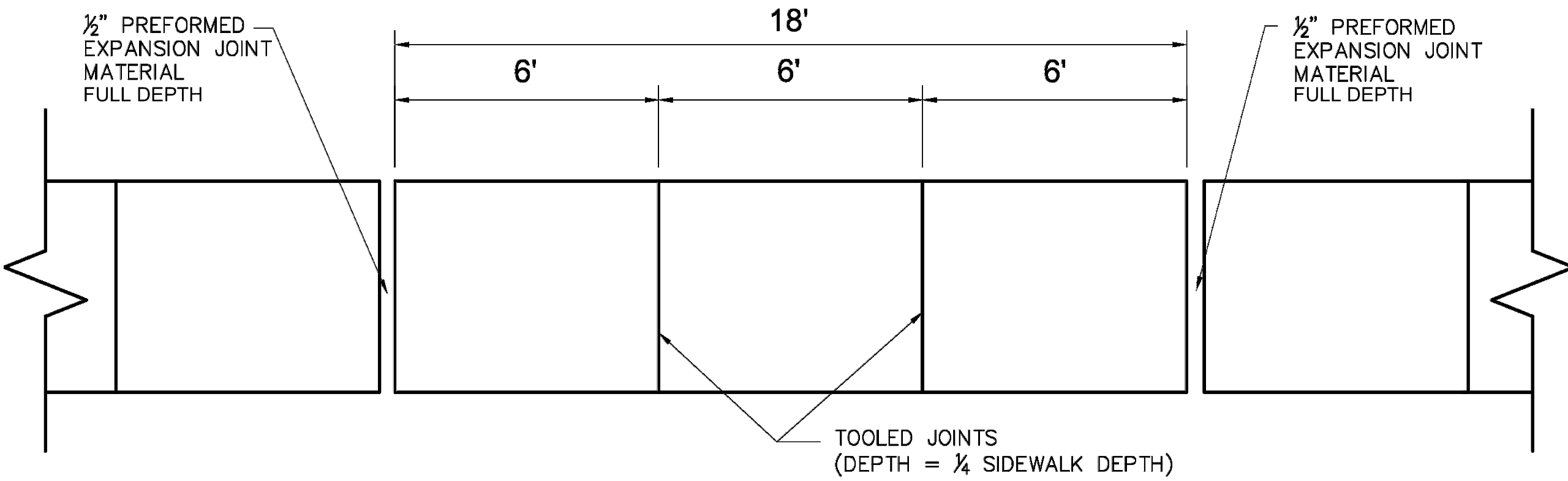

SIDEWALK PLAN VIEW
TYPICAL SIDEWALK DETAIL
N.T.S.



PREPARED BY
TOWN OF EAST HARTFORD
DEPARTMENT OF PUBLIC WORKS
ENGINEERING DIVISION