

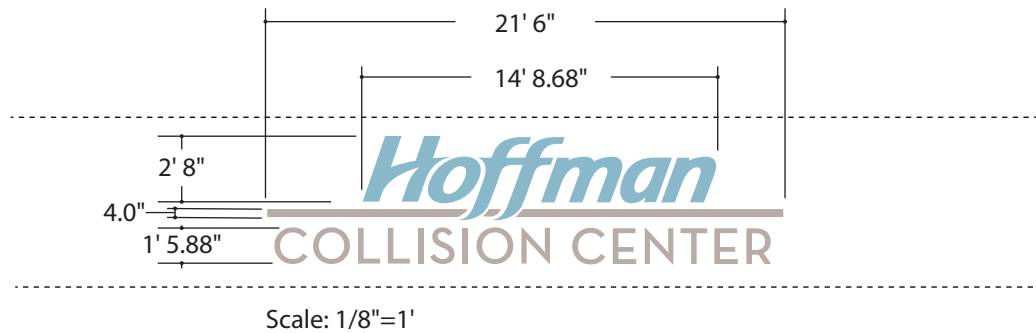

Print 6577JK-5		Date 2/20/19	ES# ES-5112	Line 2	SP MGL	Sign Type CL32
CLIENT APPROVAL			Title Hoffman Auto		Location WEST ELEVATION	
			City/State East Hartford, CT		Size 5' 4.25" x 21' 6" (115.11 sq ft)	
			Customer Hoffman Auto		Description Illuminated Channel Letterset	
			Int. Note			
AUTHORIZED SIGNATURE		DATE				
1 of 2	This drawing contains original elements created by Lauretano Sign Group, Inc., is property of Lauretano Sign Group, Inc. and is subject to all applicable copyright laws. This drawing may not be used in any way until full payment is received by Lauretano Sign Group, Inc. It is intended for review and approval purposes only, and is not to be reproduced, copied, transmitted by electronic media, or exhibited in any fashion to anyone outside your organization without the expressed written consent of Lauretano Sign Group, Inc.					

LAURETANO
SIGN GROUP

1 Tremco Drive. Terryville, CT 06786
 phone: 860.582.0233 fax: 860.583.0949
 signs@lauretano.com www.lauretano.com



Existing condition

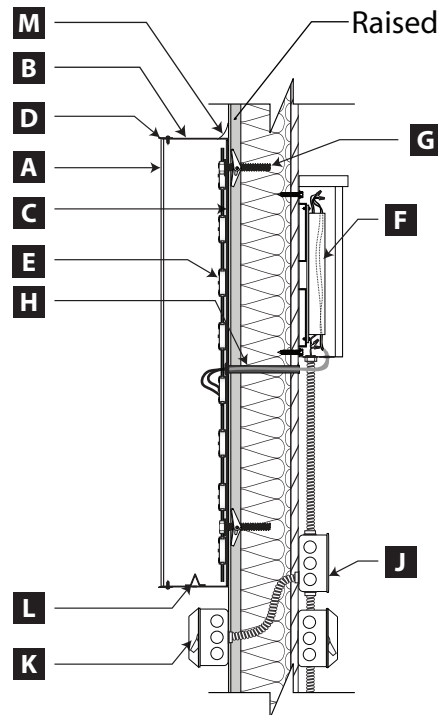

- A** FACES: .177" thk. White Acrylic Faces
- B** RETURNS: .040 aluminum coil, 5" Deep.
- C** BACKS: .063 aluminum CAD-cut
- D** TRIM: 1" Jewelite
- E** L.E.D.'S: Sloan White LED Modules
- F** POWER SUPPLIES: Remote Power Supplies mounted in transformer enclosures.
- G** HARDWARE: TOGGLE BOLT INTO EACH RAISED RIB.
- H** WALL BUSTER OR EQUIVALENT: PLTC CABLE, SEAL PASSTHRU w/ SILICONE
- J** J-BOX with PRIMARY ELECTRICAL LOCKABLE PRIMARY DISCONNECT SWITCH (BY OTHERS)
- K** ADJACENT SIGN DISCONNECT SWITCH (BY OTHERS, WHERE REQUIRED BY LOCAL CODE)
- L** WEEP HOLES IN LOW POINTS (2) MIN.
- M** SILICONE BEAD ON UNSEEN TOP EDGES

NOTES

1. LIGHT-ENHANCEMENT PAINT TO BE APPLIED TO CL INTERIORS.
2. UL LABELS REQUIRED - INSTALL IN ACCORDANCE WITH NEC
3. PRIMARY ELECTRICAL BY OTHERS.

COLORS

White Acrylic faces w/1st surface applied Digitally Printed PSV Graphics. (Hoffman Blue & Gray Color Spec. TBD)
Black Jewelite trim
Anodized Aluminum Returns.
White LED Illumination.
Faces light color day/ color night.

NOTES

Letter depth 5" to match existing lettersets.
Verify Face Colors.
Font: Helvetica Neue 85 Heavy
Building colors shown for illustration purposes only.
Painting by Others

Typical Channel Letter Mounting (NTS)

Note: For preliminary design purposes only.
Accurate field survey and dimension verification required before beginning construction.

Volt: 120 - Power is based off 120 volt.
If signs use anything other than 120 volt, then a difference in price will apply or a step down transformer will need to be used.

PROCEED TO PRODUCTION

Print 6577JK-5

Date 2/20/19

Installation Method

ES# ES-5112

Line 2

Toggle bolt

6 = Critical Dimension for Internal Quality Control

UL FILE NO. E70436

Amps

Volts 120

AUTHORIZED SIGNATURE

DATE

2 of 2

This drawing contains original elements created by Lauretano Sign Group, Inc., is property of Lauretano Sign Group, Inc. and is subject to all applicable copyright laws. This drawing may not be used in any way until full payment is received by Lauretano Sign Group, Inc. It is intended for review and approval purposes only, and is not to be reproduced, copied, transmitted by electronic media, or exhibited in any fashion to anyone outside your organization without the expressed written consent of Lauretano Sign Group, Inc.

LAURETANO
SIGN GROUP

1 Tremco Drive., Terryville, CT 06786 • Phone: 860.582.0233
signs@lauretano.com www.lauretano.com



Proposed Condition

Print 6578JK-6	Date 02/20/19	ES# ES-5112	Line 1	SP MGL	Sign Type CL32
CLIENT APPROVAL		Title	Hoffman Auto		Location NORTH ELEVATION
		City/State	East Hartford, CT		Size 5' 4.25" x 21' 6" (115.11 sq ft)
		Customer	Hoffman Auto		Description Illuminated Channel Letterset
		AUTHORIZED SIGNATURE	DATE	Int. Note	
1 of 2	This drawing contains original elements created by Lauretano Sign Group, Inc., is property of Lauretano Sign Group, Inc. and is subject to all applicable copyright laws. This drawing may not be used in any way until full payment is received by Lauretano Sign Group, Inc. It is intended for review and approval purposes only, and is not to be reproduced, copied, transmitted by electronic media, or exhibited in any fashion to anyone outside your organization without the expressed written consent of Lauretano Sign Group, Inc.				

LAURETANO
SIGN GROUP

1 Tremco Drive. Terryville, CT 06786
phone: 860.582.0233 fax: 860.583.0949
signs@lauretano.com www.lauretano.com

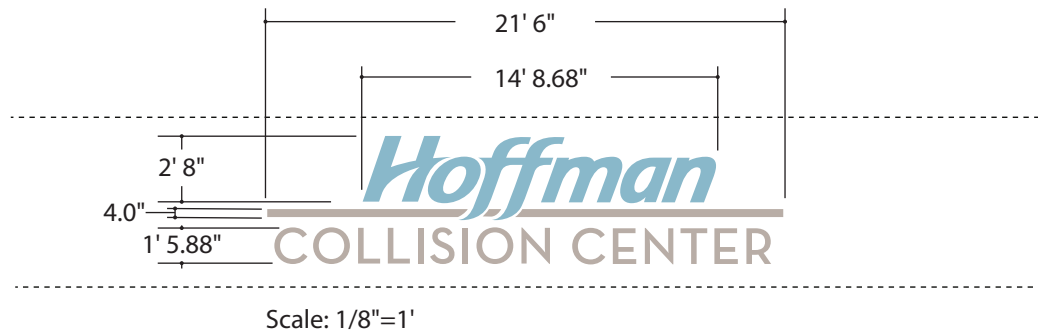

Existing condition

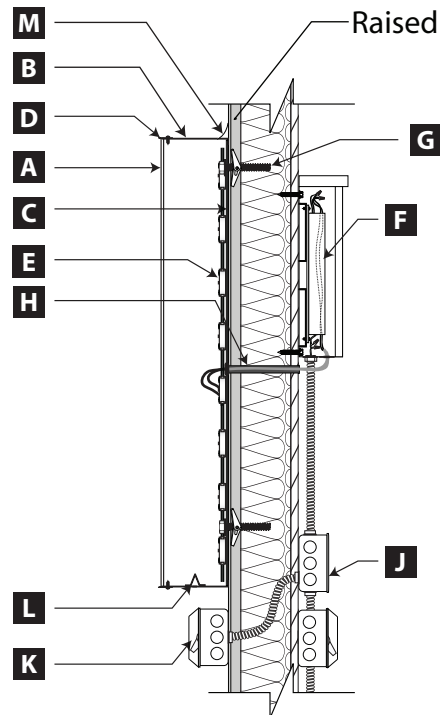

- A** FACES: .177" thk. White Acrylic Faces
- B** RETURNS: .040 aluminum coil, 5" Deep.
- C** BACKS: .063 aluminum CAD-cut
- D** TRIM: 1" Jewelite
- E** L.E.D.'S: Sloan White LED Modules
- F** POWER SUPPLIES: Remote Power Supplies mounted in transformer enclosures.
- G** HARDWARE: TOGGLE BOLT INTO EACH RAISED RIB.
- H** WALL BUSTER OR EQUIVALENT: PLTC CABLE, SEAL PASSTHRU w/ SILICONE
- J** J-BOX with PRIMARY ELECTRICAL LOCKABLE PRIMARY DISCONNECT SWITCH (BY OTHERS)
- K** ADJACENT SIGN DISCONNECT SWITCH (BY OTHERS, WHERE REQUIRED BY LOCAL CODE)
- L** WEEP HOLES IN LOW POINTS (2) MIN.
- M** SILICONE BEAD ON UNSEEN TOP EDGES

NOTES

1. LIGHT-ENHANCEMENT PAINT TO BE APPLIED TO CL INTERIORS.
2. UL LABELS REQUIRED - INSTALL IN ACCORDANCE WITH NEC
3. PRIMARY ELECTRICAL BY OTHERS.

COLORS

White Acrylic faces w/1st surface applied Digitally Printed PSV Graphics. (Hoffman Blue & Gray Color Spec. TBD)
Black Jewelite trim
Anodized Aluminum Returns.
White LED Illumination.
Faces light color day/ color night.

NOTES

Letter depth 5" to match existing lettersets.
Verify Face Colors.
Font: Helvetica Neue 85 Heavy
Building colors shown for illustration purposes only.
Painting by Others

Typical Channel Letter Mounting (NTS)

Note: For preliminary design purposes only.
Accurate field survey and dimension verification
required before beginning construction.

Volt: 120 - Power is based off 120 volt.
If signs use anything other than 120 volt,
then a difference in price will apply or a step
down transformer will need to be used.

PROCEED TO PRODUCTION

Print 6578JK-6

Date 02/20/19

Installation Method

ES# ES-5112

Line 1

Toggle bolt

6 = Critical Dimension for
Internal Quality Control

UL FILE NO. E70436

Amps

Volts 120

AUTHORIZED SIGNATURE

DATE

2 of 2

This drawing contains original elements created by Lauretano Sign Group, Inc., is property of Lauretano Sign Group, Inc. and is subject to all applicable copyright laws. This drawing may not be used in any way until full payment is received by Lauretano Sign Group, Inc. It is intended for review and approval purposes only, and is not to be reproduced, copied, transmitted by electronic media, or exhibited in any fashion to anyone outside your organization without the expressed written consent of Lauretano Sign Group, Inc.

LAURETANO
SIGN GROUP

1 Tremco Drive., Terryville, CT 06786 • Phone: 860.582.0233
signs@lauretano.com www.lauretano.com



NOTE: Actual position of sign may differ

Print 8278JK-2	Date 2/20/19	ES# ES-5112	Line 8	SP ML	Sign Type Pylon	<div>LAURETANO SIGN GROUP</div> <div>1 Tremco Drive. Terryville, CT 06786 phone: 860.582.0233 fax: 860.583.0949 signs@lauretano.com www.lauretano.com</div>
Hoffman Auto Group 750 Connecticut Blvd. East Hartford, CT		3' 8" x 8' 6" (31.1 sq ft) Overall Height: 22' 6"			Location As illustrated	
					Description DF pylon w/ illuminated	
					channel lettersets	
<small>This drawing contains original elements created by Lauretano Sign Group, Inc., is property of Lauretano Sign Group, Inc. and is subject to all applicable copyright laws. This drawing may not be used in any way until full payment is received by Lauretano Sign Group, Inc. It is intended for review and approval purposes only, and is not to be reproduced, copied, transmitted by electronic media, or exhibited in any fashion to anyone outside your organization without the expressed written consent of Lauretano Sign Group, Inc.</small>						

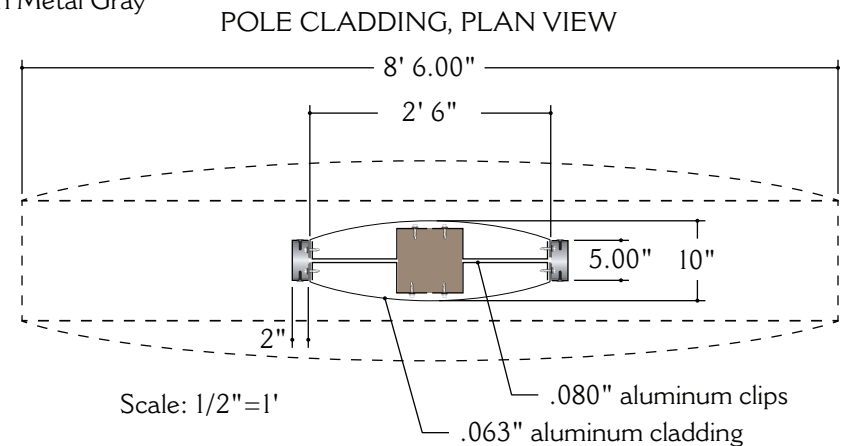
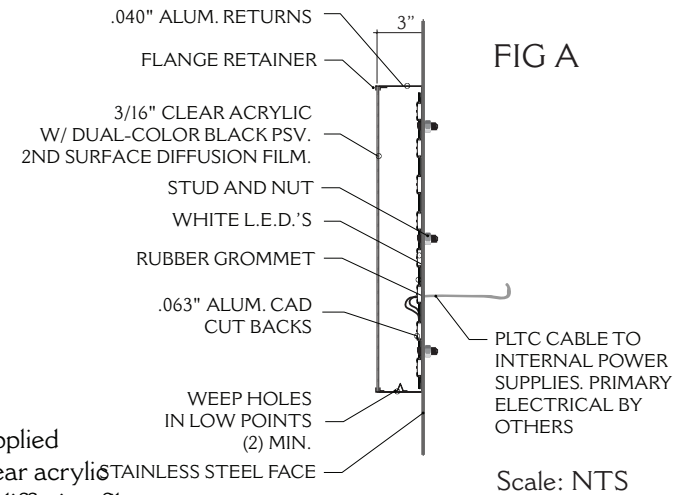
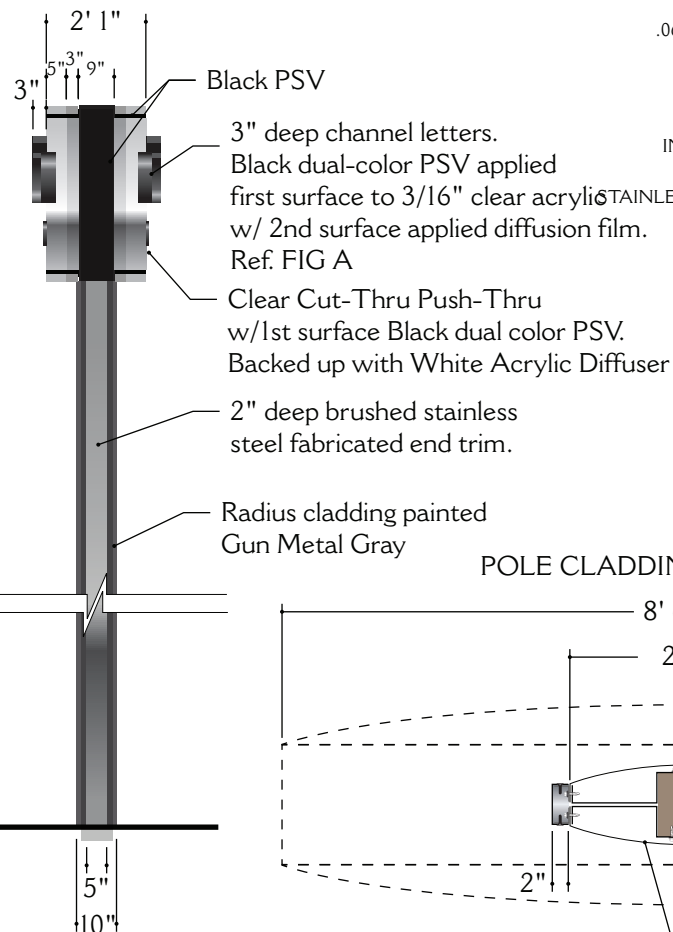
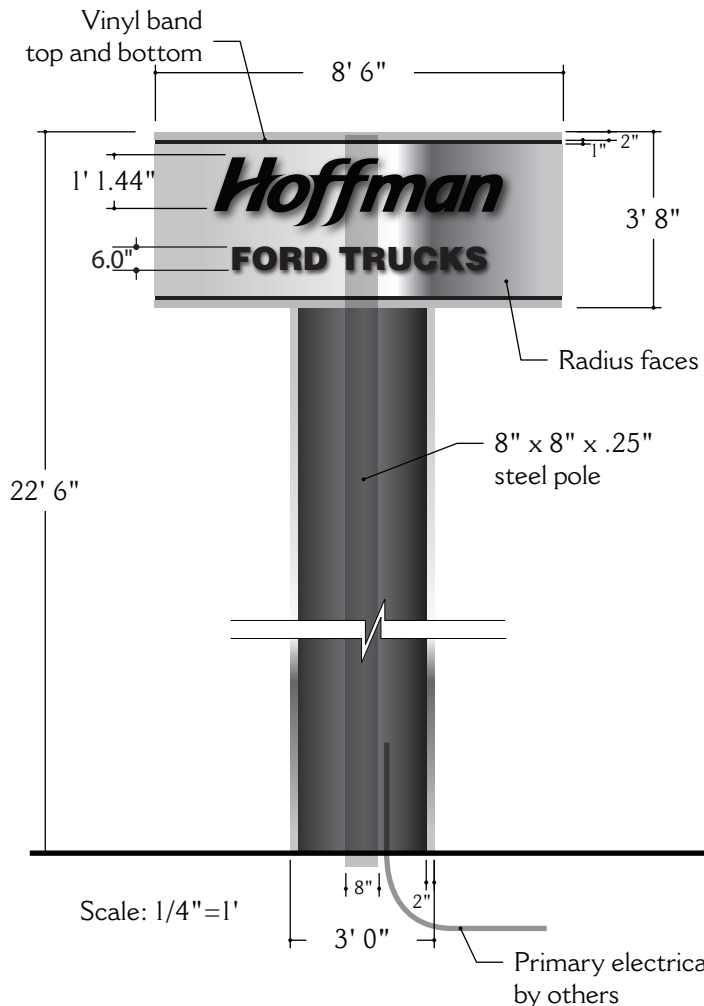
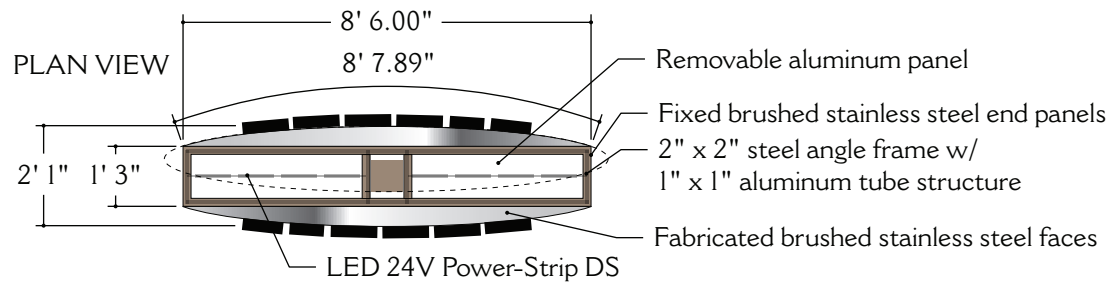

PROCEED TO PRODUCTION		Print 8278JK-2	Date 2/20/19	 LAURETANO SIGN GROUP 1 Tremco Drive., Terryville, CT 06786 • Phone: 860.582.0233 signs@lauretano.com www.lauretano.com
		ES# ES-5112	Line 8	
		6 = Critical Dimension for Internal Quality Control	UL FILE NO. E70436	
AUTHORIZED SIGNATURE	DATE			
2 of 3	This drawing contains original elements created by Lauretano Sign Group, Inc., is property of Lauretano Sign Group, Inc. and is subject to all applicable copyright laws. This drawing may not be used in any way until full payment is received by Lauretano Sign Group, Inc. It is intended for review and approval purposes only, and is not to be reproduced, copied, transmitted by electronic media, or exhibited in any fashion to anyone outside your organization without the expressed written consent of Lauretano Sign Group, Inc.			

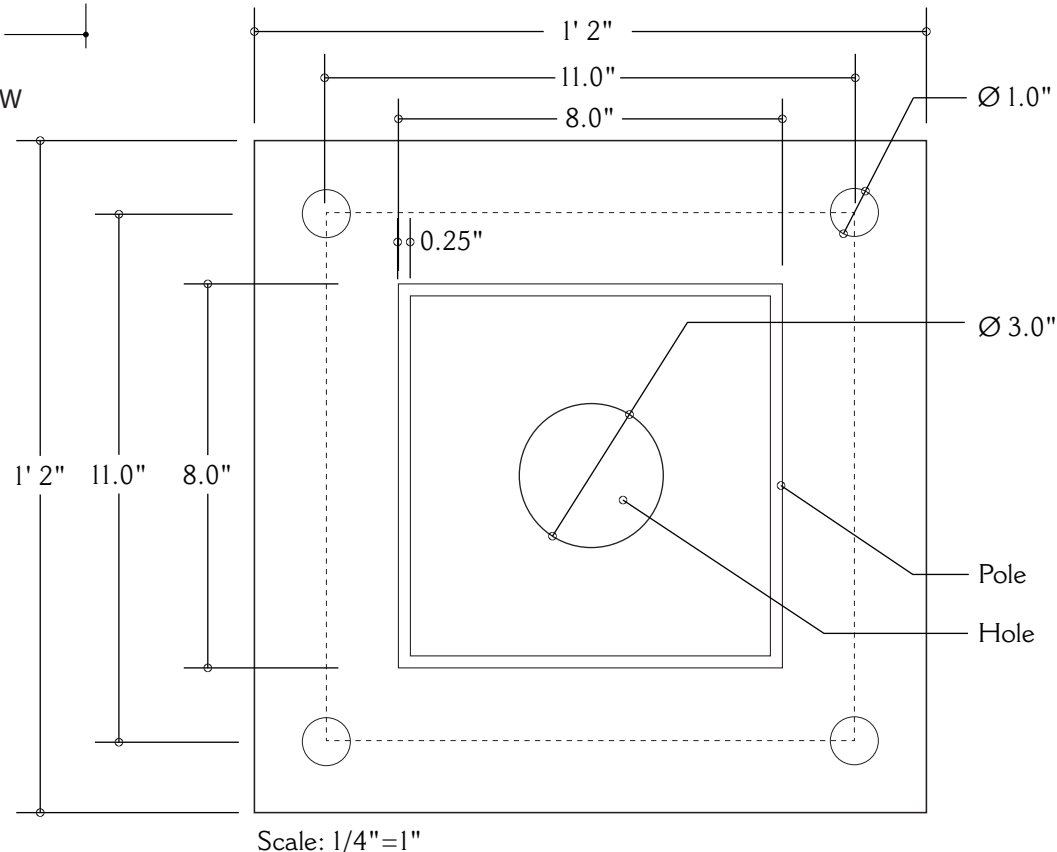
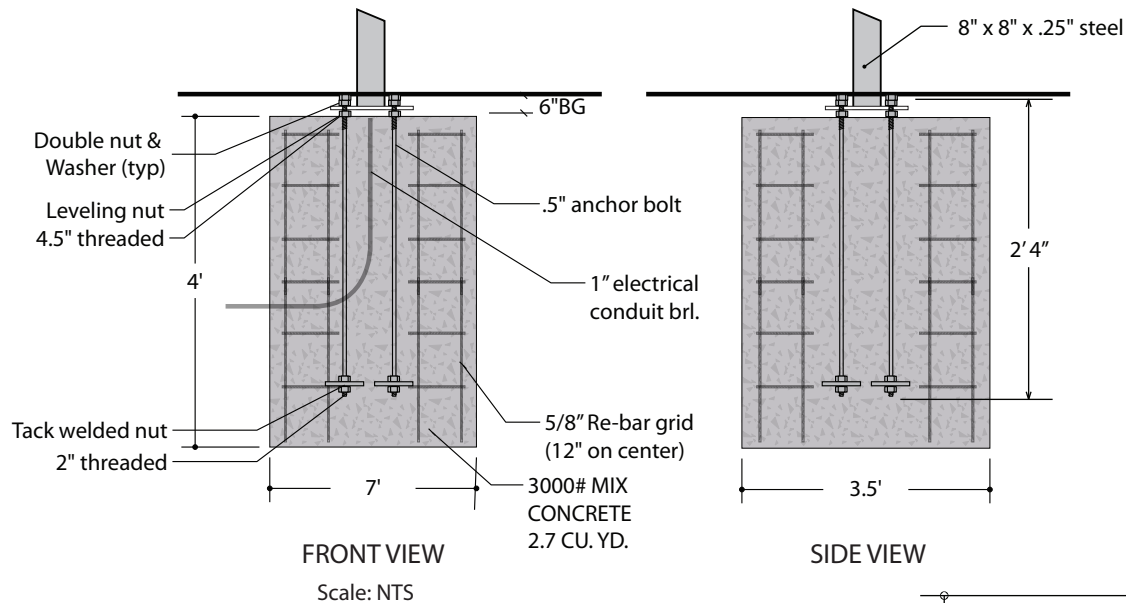

Volt: 120 - Power is based off 120 volt.
 If signs use anything other than 120 volt,
 then a difference in price will apply or a step
 down transformer will need to be used.

Note: For preliminary design purposes only.
 Accurate field survey and dimension verification
 required before beginning construction.

PROCEED TO PRODUCTION		Print 8278JK-2	Date 2/20/19	Installation Method	
		ES# ES-5112	Line 8	Spread footing	
AUTHORIZED SIGNATURE _____ DATE _____		 = Critical Dimension for Internal Quality Control	UL FILE NO. E70436		
				Amps	Volts 120
3 of 3	This drawing contains original elements created by Lauretano Sign Group, Inc., is property of Lauretano Sign Group, Inc. and is subject to all applicable copyright laws. This drawing may not be used in any way until full payment is received by Lauretano Sign Group, Inc. It is intended for review and approval purposes only, and is not to be reproduced, copied, transmitted by electronic media, or exhibited in any fashion to anyone outside your organization without the expressed written consent of Lauretano Sign Group, Inc.				
<div><div>LAURETANO SIGN GROUP</div><div>1 Tremco Drive., Terryville, CT 06786 • Phone: 860.582.0233 signs@lauretano.com www.lauretano.com</div></div>					